

APARTMENTS

- 1 BED / 1 BATH
- 1 BED / 1 BATH + STUDY
- 2 BEDS / 2 BATHS
- 2 BEDS / 2 BATHS + STUDY
- 3 BEDS / 2 BATHS

TOWNHOMES

- 2 BEDS / 2.5 BATHS
- 2 BEDS / 3.5 BATHS
- 3 BEDS / 3.5 BATHS

AMENITIES

- BIKE STORAGE
- CAR CARE CENTER
- CHARGING STATION
- DOG PARK
- DOG SPA
- ELEVATORS
- MAIL
- PARK
- PET STATION
- RETAIL
- STORAGE
- TRASH
- VISITOR PARKING SPOTS

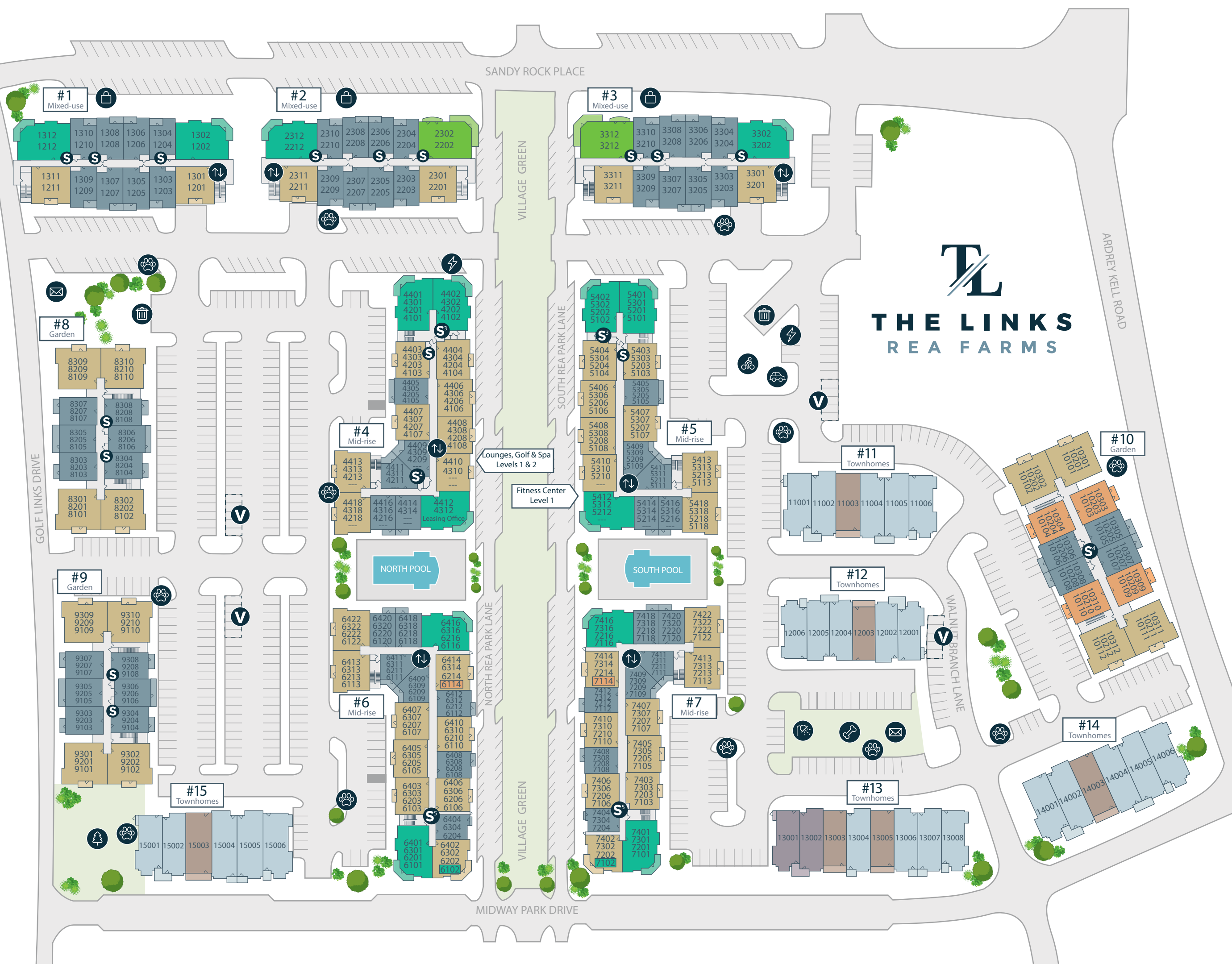

THE LINKS
REAL FARMS

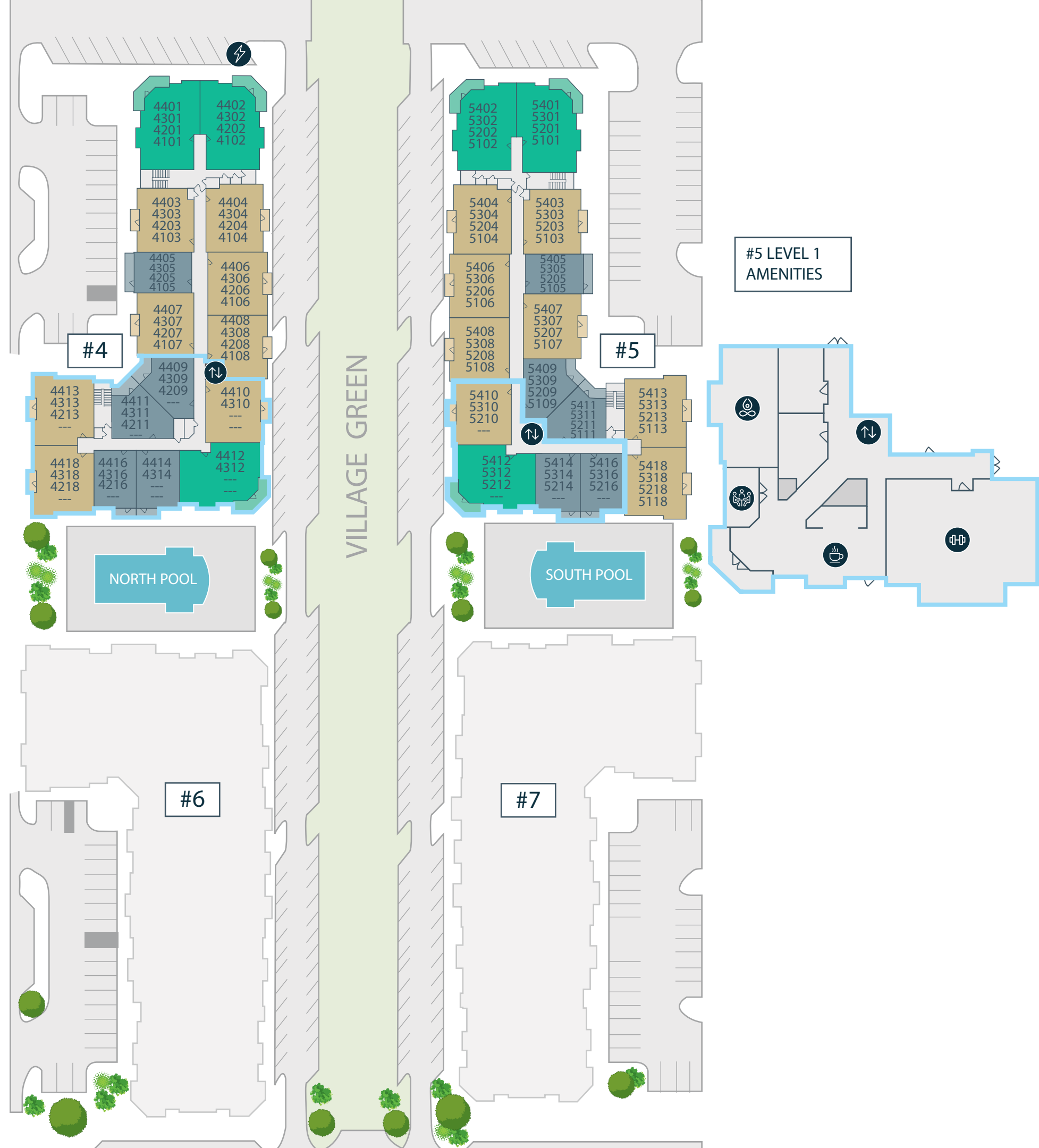
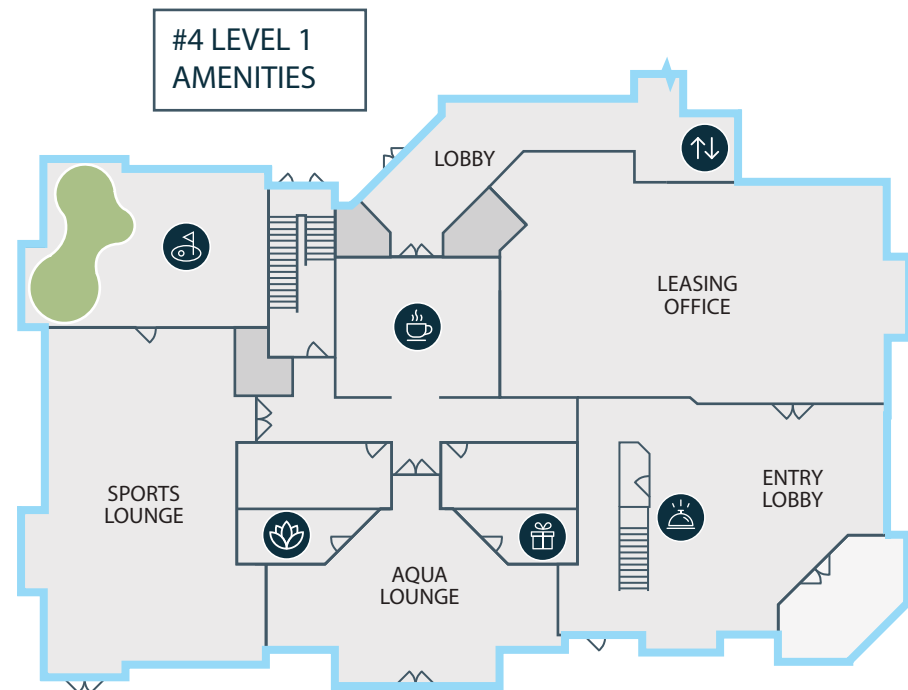

APARTMENTS

- 1 BED / 1 BATH
- 1 BED / 1 BATH + STUDY
- 2 BEDS / 2 BATHS
- 2 BEDS / 2 BATHS + STUDY
- 3 BEDS / 2 BATHS

AMENITIES

- BUSINESS SUITE
- CHARGING STATION
- CONCIERGE
- CONFERENCE ROOM
- ELEVATORS
- FITNESS CENTER
- GIFT WRAP SUITE
- PARCEL CAFÉ
- SPA SUITE
- VIRTUAL FITNESS STUDIO
- VIRTUAL GOLF